

HUSKY™

MOBILE MANIPULATOR

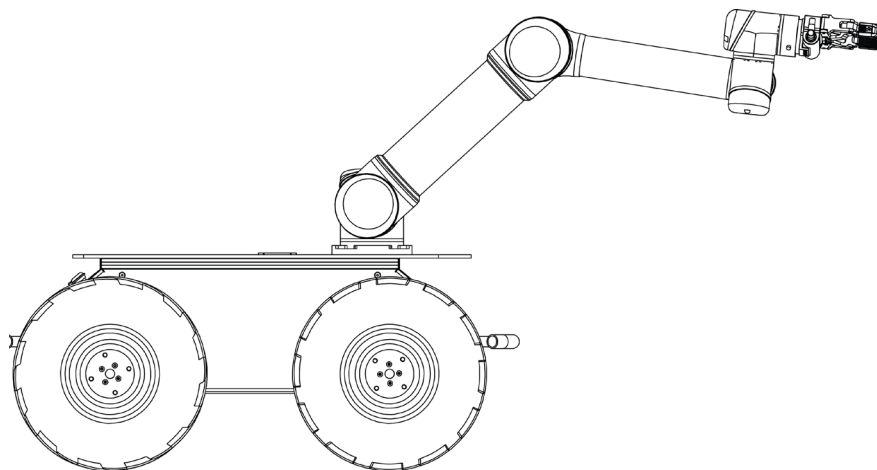

TECHNICAL SPECIFICATIONS

ROBOTIQ 3-FINGER ADVANCED GRIPPER

| | |
|-----------------------------|--------------------|
| GRIPPER STROKE | 155 mm (6.1 in) |
| GRIPPER WEIGHT | 2.3 kg (5 lbs) |
| MAX PAYLOAD | 10 kg (22 lbs) |
| PARALLEL GRIP REPEATABILITY | 0.05 mm (0.002 in) |

UNIVERSAL ROBOTICS UR5 MANIPULATOR

| | |
|--------------------|---|
| REACH | 850 mm (33.5 in) |
| DEGREES OF FREEDOM | 6 Rotating Joints |
| PAYLOAD | Without Gripper: 5 kg (11 lb) With Gripper: 7.3 kg (16.1 lb) |
| REPEATABILITY | +/- 0.1 mm (0.0039 in) |

SIZE AND WEIGHT (HUSKY BASE)

| | |
|---------------------------------|--|
| EXTERNAL DIMENSIONS (L x W x H) | 990 x 670 x 390 mm (39 x 26.4 x 14.6 in) |
| WEIGHT | 50 kg (110 lb) |
| WHEELS | 330 mm (13 in) Lug Tread |
| GROUND CLEARANCE | 130 mm (5 in) |

SPEED AND PERFORMANCE (HUSKY BASE)

| | |
|--------------------------|----------------------|
| MAX PAYLOAD | 75 kg (165 lb) |
| MAX SPEED | 1.0 m/s (2.3 mph) |
| DRIVETRAIN / DRIVE POWER | 4x4 Zero-Maintenance |
| MAX CLIMB GRADE | 45° (100% Slope) |

INTERFACING AND COMMUNICATION

| | |
|------------------|---|
| CONTROL MODES | Husky: Direct voltage, wheel speed, and kinematic velocity. Arm: Position and velocity commands, MoveIT! inverse kinematics and motion planning. |
| FEEDBACK | Battery voltage, motor currents, wheel odometry, and control system output. |
| COMMUNICATION | RS232 @ 115200 baud |
| DRIVERS AND APIs | ROS, Gazebo, RViz, MoveIT!, C++ interface available. |

ENVIRONMENTAL

| | |
|-------------------------------|----------------------------|
| OPERATING AMBIENT TEMPERATURE | -10 to 30 °C (14 to 86 °F) |
|-------------------------------|----------------------------|

Contact us today for pricing and a free 30 minute technical assessment: **1-800-301-3863**